

SLIM HOOD

EFCH9111HM SS



THE BEAUTY OF SIMPLICITY



USER MANUAL

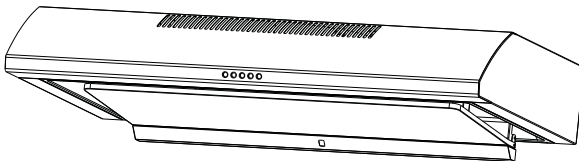

Table of Contents

• From the Manufacturer	2
• Specifications	2
• SAFETY: Read this before installation	3
• Description of Parts	4
• Re-circulating Mode	5
• Installation	6
• Operation	7
• Cleaning & Maintenance	8
• Troubleshooting	9

From the Manufacturer

- This appliance and the packaging are produced with the process to minimize waste and respect the environment.
- Please help us continue the protection of the environment by disposing the packaging in a correct way.
- Please do not allow young children to play with the plastic bag packaging.
- Before disposing of any old appliances, be sure to cut off the power cord for safety purpose

Specifications

Input : 220-240V 50Hz

Power

Motor : 150W

LED light : 2 x 1W

Total Power : 152W

Dimension(WxDxH) : 898x530x140mm

SAFETY: Read this before installation

- Do not connect the appliance if there are obvious sign of transportation damage.
- Read this user manual carefully before attempting to use this appliance
- Installation and repair should be attempted only by qualified technical personnel.
- It is dangerous to modify any part of this appliance.
- The manufacturer declines all responsibility in case of failure to adopt proper safety measures.
- Ensure the location in which this appliance is installed has good, permanent ventilation.
- The distance between the bench top to the lower part of the hood must not be less than 65cm or higher than 75cm.
- Check that the voltage in your area is correct before plugging in.
- The electrical connection of this appliance must be connected to earth.

Green & yellow = **EARTH**

Blue = **NEUTRAL**

Brown = **LIVE**

- Multiple plugs and extension cables must not be used. Overload is dangerous and may cause a fire.
- Ensure that the power supply cord is free from any heat source or sharp objects.
- The appliance should be switched off and the electrical supply disconnected before any cleaning or maintenance work can be carried out.

Description of Parts

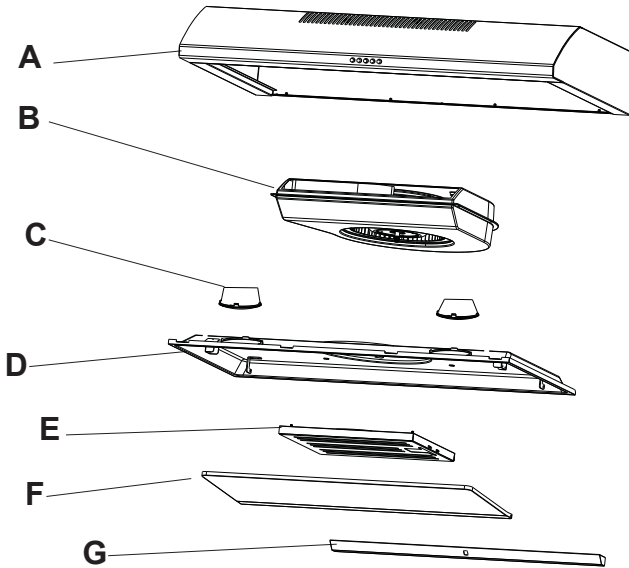

A: Main body

B: Motor housing + fan motor

C: LED lights

D: Body cover plate

E: Aluminium filter with charcoal (2 in 1 filter)

F: Oil collecting plate

G: Oil collecting cup

10 screws

4 screws(4mmxL12mm) are used for installing the brackets to hood as Method 1-step 1.
2 screws(4mmxL50mm) are used for fixing the hood to wall as Method 1 - step 2
4 screws(4mmxL50mm) are used for fixing hood unit as method 2 - step 2



2 "L" metal brackets

Re-circulating Mode

This cooker is operated in re-circulating mode only.

In re-circulating mode, the aluminium filter with charcoal (2 in 1 filter) must be installed. Fumes are filtered through the 2 in 1 filter to remove grease and odour, and re-introduced into the kitchen environment.

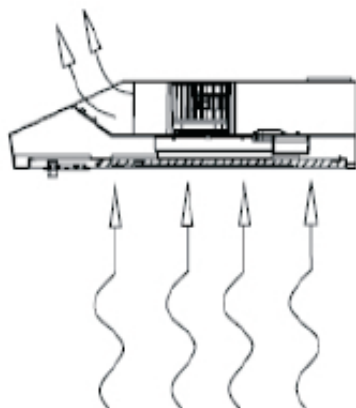

Installation

Method 1

Step 1: Fix L metal bracket x2 on the cooker hood as "A"

Step 2: Fix the screws x2 on the wall as "B"

Step 3: Hang the hood and tighten the screws completely as "C"

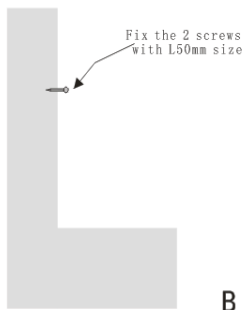
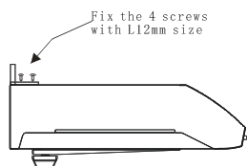

Method 2

Step 1: Loosen 3 screws on hood body to take out oil tray plate, oil collecting cup. Remove aluminium charcoal filters, as "A".

Step 2: Fix the hood on the cupboard with 4 screws as "B"

Step 3: Install back the oil collecting plate, oil collecting cup and aluminium charcoal filter as "C"

Step 4: The complete installation picture as "D"

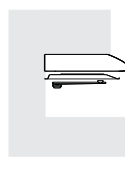
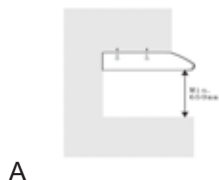
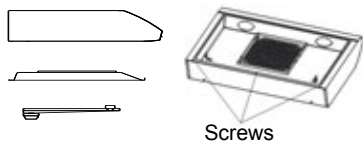

Operation

The hood is equipped with 3 speed control.

Use the low speed for simmering, medium speed for light cooking.

Use the high speed for frying or heavy cooking.

It is also equipped with light bulb to illuminate your cooking area when needed.

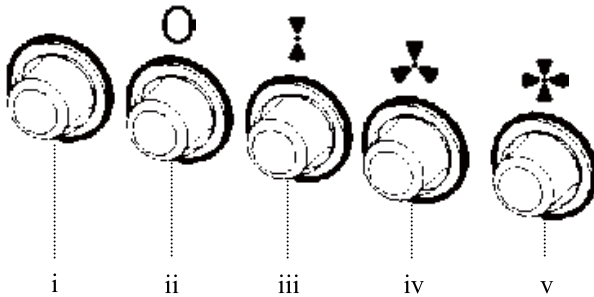

Light On/Off Button (i)

On/Off switch for the light. Push the button in to turn the light ON, push again to turn the light OFF.

Blower Off Button (ii)

Off switch for the blower. Push the button in to turn the blower OFF.

Blower On and Speed Buttons (iii, iv & v)

Button (iii) operates the blower on LOW speed.

Push button (iv) for MEDIUM speed.

Push button (v) for HIGH speed.

Cleaning & Maintenance

SURFACE: Wash with warm soapy water and a soft sponge. Never use abrasive detergent, scouring pads, steel wool or solvents on any part of this appliance as this will cause irreparable damage.

ALUMINIUM CHARCOAL FILTERS: charcoal cannot be reused, they must be replaced once a year or depending on the frequency of appliances usage.

OIL COLLECTING CUP/OIL COLLECTING PLATE: Wash in the dishwasher or soak the panel in a degreasing agent for an hour, then rinse off.

For this appliance to function effectively, regular maintenance is a must. Clogged filters restrict airflow and may cause the motor overheat.

Troubleshooting

Symptoms	Possible Cause	Action
Not functioning	No electrical supply	Check that the plug is connected
		Check that the main switch is turned on
Poor airflow	2 in 1 filter clogged	Clean the filter and put it back when dry
Motor running but no airflow	Butterfly valve jammed	Contact Customer Service
Motor cut off after a few minutes	High temperature safety device activated	The kitchen is not sufficiently ventilated
	The hood is installed too near to the cooking stove	The hood must be at least 65cm from stove
Strong cooking smell	2 in 1 filter not installed	Aluminium charcoal filter must be installed
	2 in 1 filter clogged	Clean the filter and put it back when dry or replace with a new one
Whirring sound	Foreign object in contact with fan blade	Contact Customer Service

For original parts & reliable service

CASA(S) PTE LTD
15 KIAN TECK CRESCENT,
SINGAPORE 628884
TEL:+65 6268 0077
FAX:+65 6898 0510
Email:service@casa.com.sg